

GA12 Wing Remote-Action Lock Unit

Features

- The 'Turn-Button' lock is fitted with a direct-action operating bar, making it an extremely low-profile handle for securing doors or for driving rod mechanisms
- Rotation is 90° LH. Key operates only when handle is horizontal, but key withdraws in both locked positions

Material

- Steel, bright chromium plated or black powder coated

Notes

- Insert from front into pierced aperture and fix with large hexagon nut
- Neoprene gasket and stainless spring washer are provided
- Can pawl can be fitted at 90° intervals
- 'FT' keys as standard with 'shuttered' keyway. Optionally 'FS' or 'DLP' key types also available



GA12-G01861

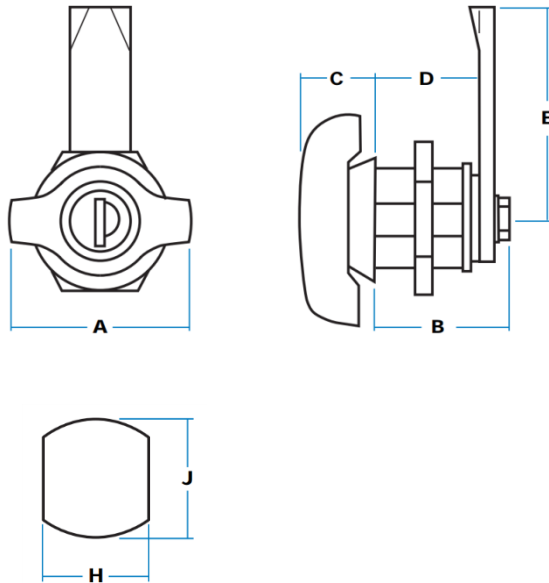

90° LH MOVEMENT

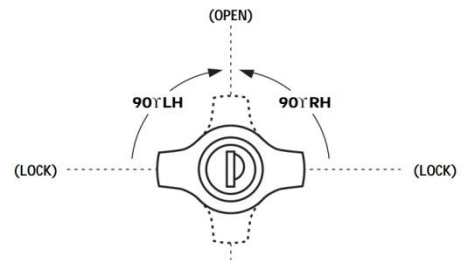

Handles operate LH (clockwise) but lock in horizontal position only. Key does not withdraw in 'open' position.

Part No.	Rotation	Key	A	B	C	D	E	H	J
GA12-01861	90° LH	Standard	45	37	14	30	48	22	24
GA12-01861-01		FT111							

G00097
Cranked
'down'



G00275
'Straight'



G00276
Cranked 'up'



Cam Pawl Options

- Straight cam pawl is fitted as standard
- Other available options (sold separately) include cranked 9.5mm 'up' or 'down' cam pawls
- Lock will accept all other cam pawls with 8 mm piercing, including 2 / 3-point options

Cam Form and Multi-Point Cam Pawls

Features

- These pawls are in 3 mm thick mild steel, zinc plated with 8 mm square hole
- Cam-form types have a 4 mm 'leading edge' for good engagement. They can be used with most of our compartment locks, 'Compact' and 'Turn-button' models, and also with handles having 8 mm square shaft, as illustrated below.

Cam-Form Cam Pawls



G00276



G00275



G00097

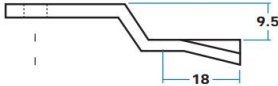

Cam-Form Cam Pawls



G02706
(Raised 23 mm)

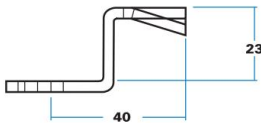

G02721
(Raised 30 mm)

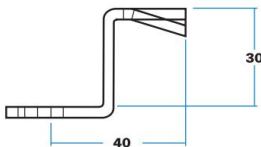

Two-Point Cam Pawls



G00508 (illustrated)
G01911 (with in-line square)

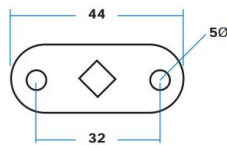

G00789 (illustrated)
G01389 (with square at 45° to centre line)

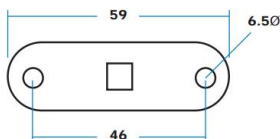

Cam Pawl Fitted To Locking Handles



The 8 mm shaft is threaded M10 so that square form is retained. Cam Pawl can be adjusted using nut (GMP00221) and locknut (GMP00220) illustrated